



TOYOTA

ALWAYS A
BETTER WAY

How to activate MyT app connected services



Connected
Services

MyT app connected services

Connected services is the set of services designed to make your life with your Toyota vehicle, easier and more fun.



Hybrid coaching



Driving Data



Service reminders



Share to Car



Find my car



Warning lights

To access those features you need to activate the connected services. We will guide you through the process in this tutorials.

Note: Please refer to Toyota website for connected services applicable to your vehicle.

MyT

Activate connected services: Overview

Step 1 – From the homepage click on the wheel icon  .

Step 2 – Click on “Settings”.

Step 3 – Click on “Car”.

Step 4 – Click on “Activate connected services”.

Step 5 – Click on “Terms of use & Privacy Notice” & approve.

Step 6 – Get into your car, switch the ignition ON and read your car mileage .

Step 7 – Enter the car mileage in the app.

Step 8 – Switch the ignition OFF.

Step 9 – Drive your car faster than 10k/h to activate the services and see it in your app.

How & when to remove the car from your account?

Activate connected services: Step 1

From the homepage, click on the wheel icon .

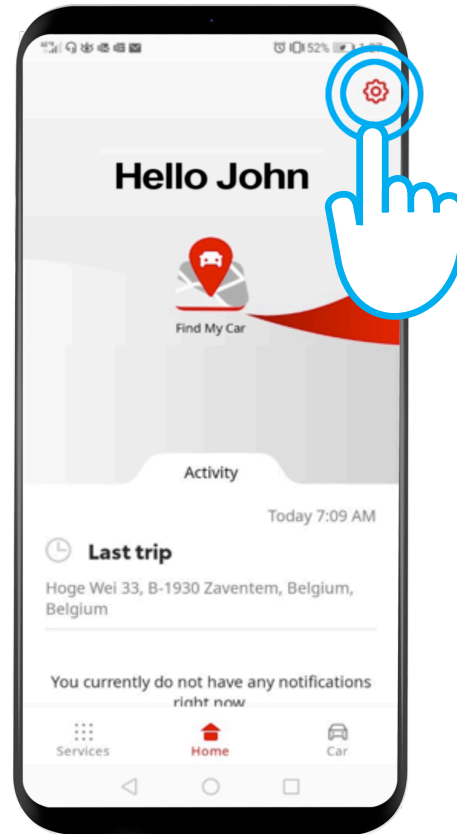

Activate connected services: Step 2

Click on “Settings”.

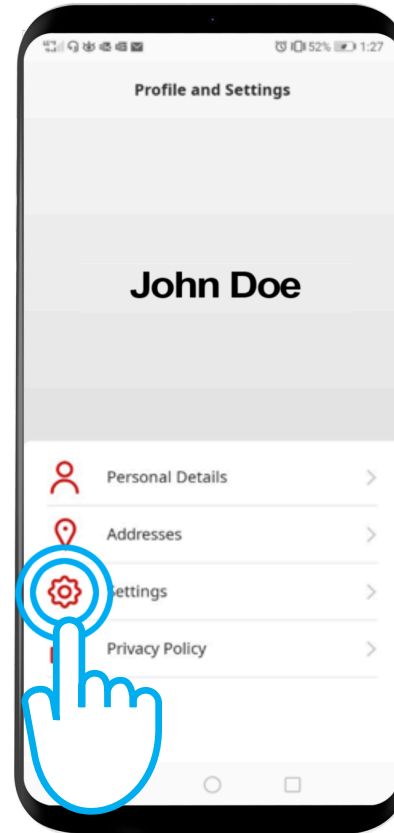

Activate connected services: Step 3

Click on the “Car” tab.

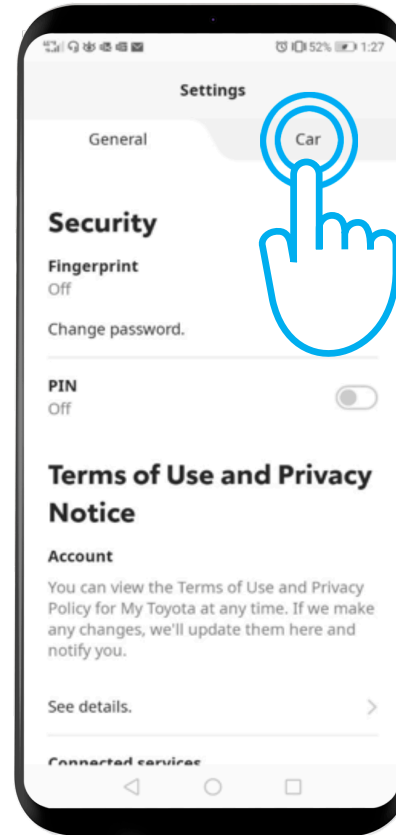

Activate connected services: Step 4

Click on “Activate connected services”.

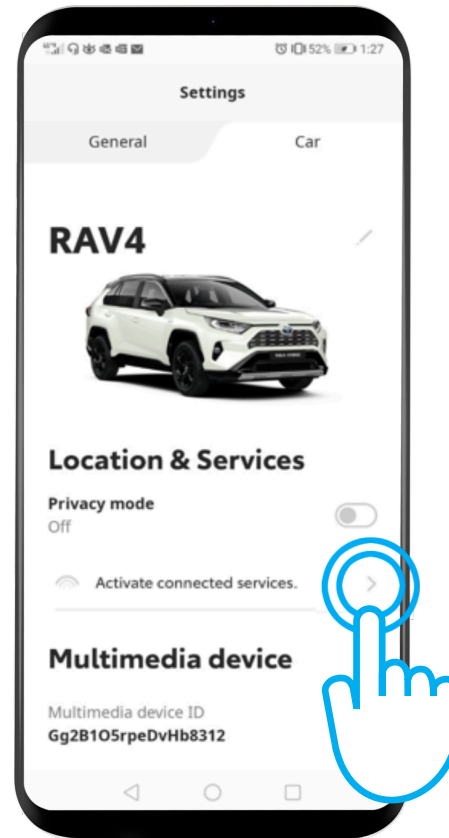

Activate connected services: Step 5

Click on “Terms of Use and Privacy Notice”.

Consent is required to enjoy connected services.



End user entitlement: Step 6 & 7

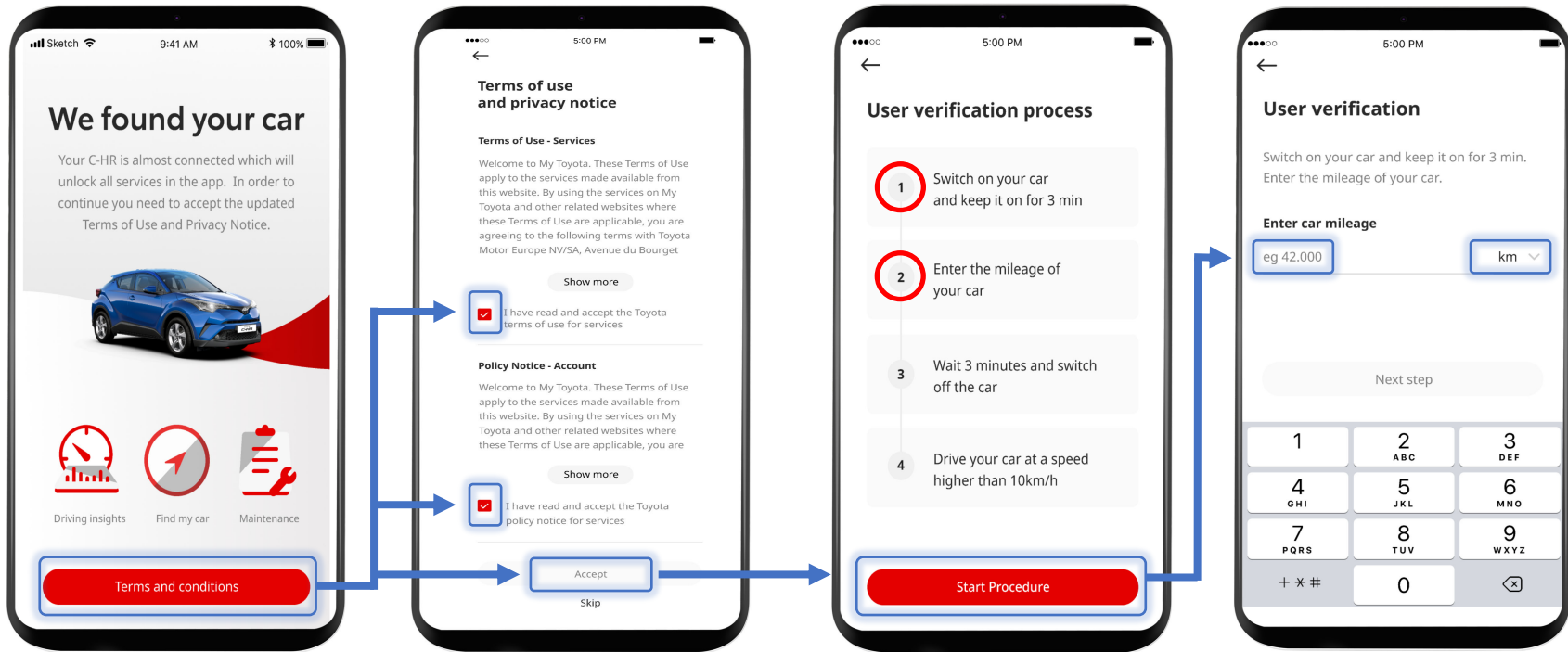

Note: After 3 wrong mileage inputs, please contact your favorite dealer

End user entitlement: Step 8 & 9

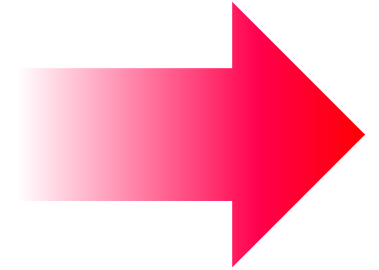
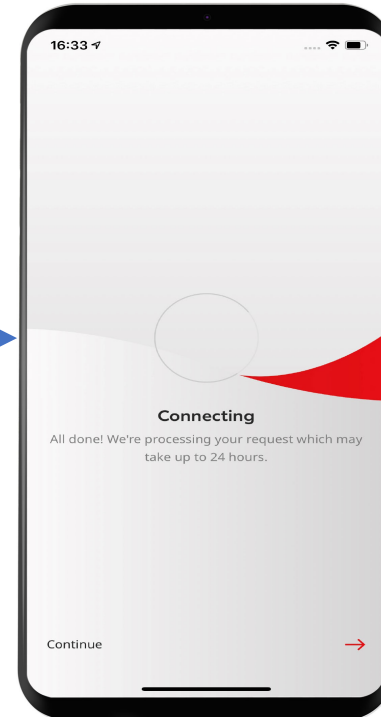
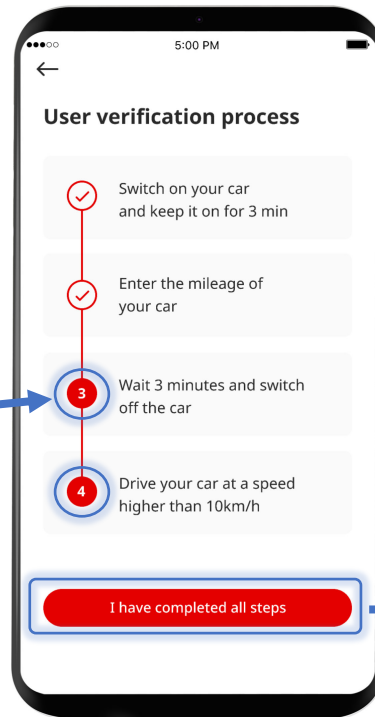
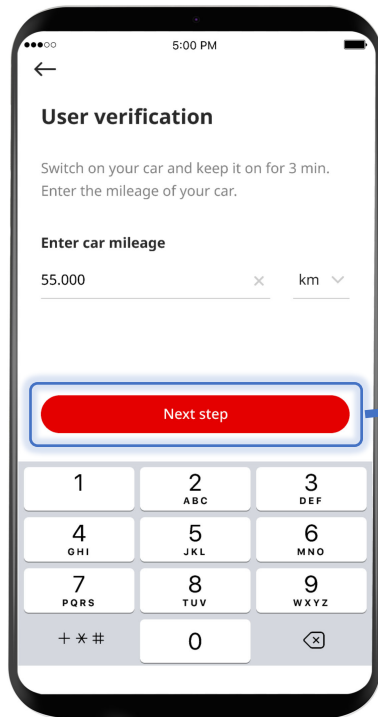

Activated connected services:

Congratulations, you can now enjoy your set of connected services

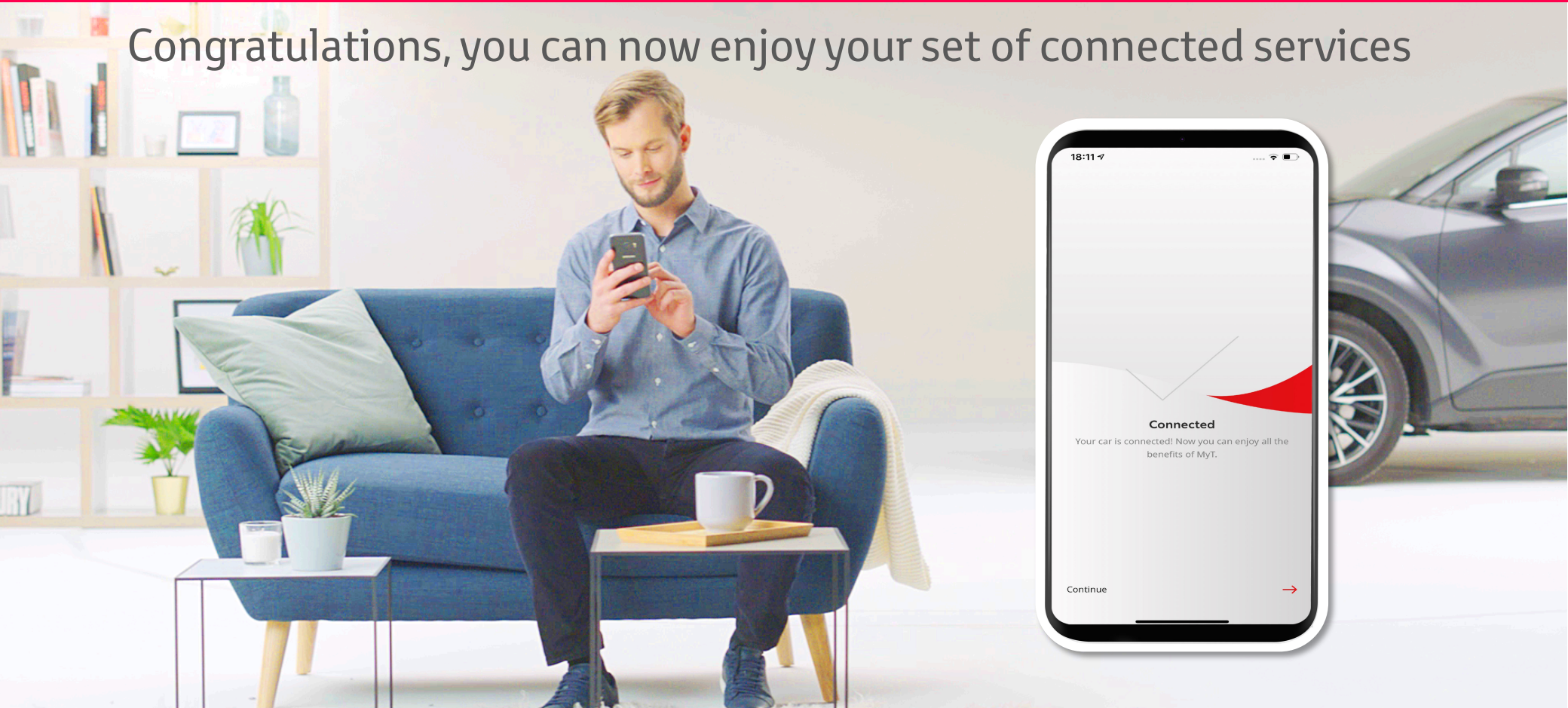

When to remove the car from your account?

When:

- ✓ stops using the car because:
 - Car has been sold
 - Usage period is finished

You should remove that car from your account.

How to remove the car from your account?

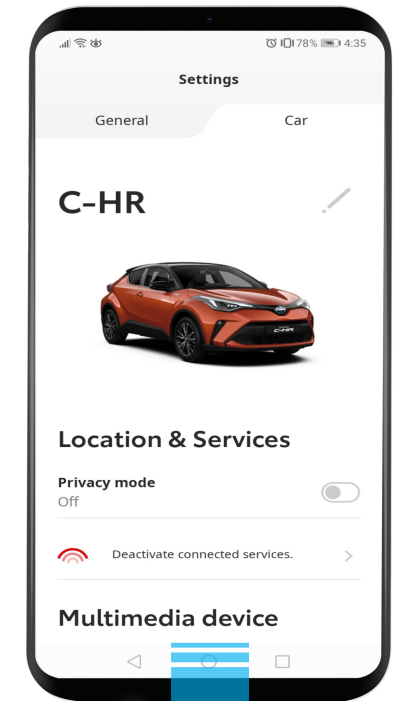
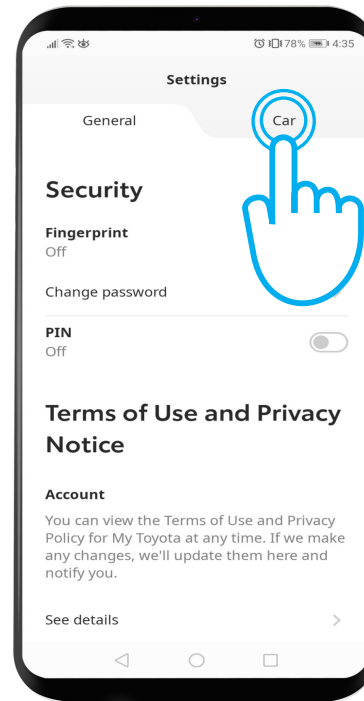
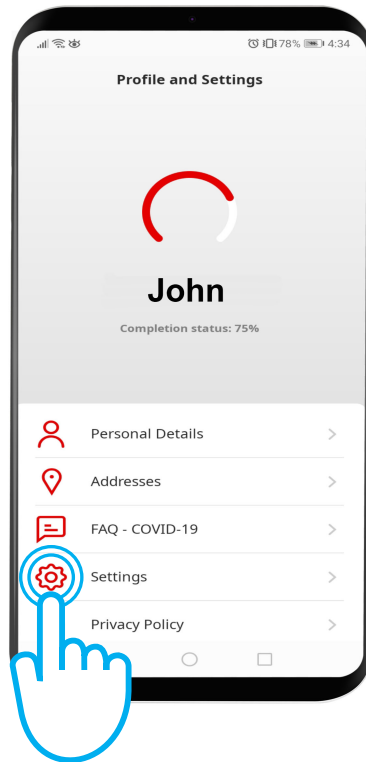
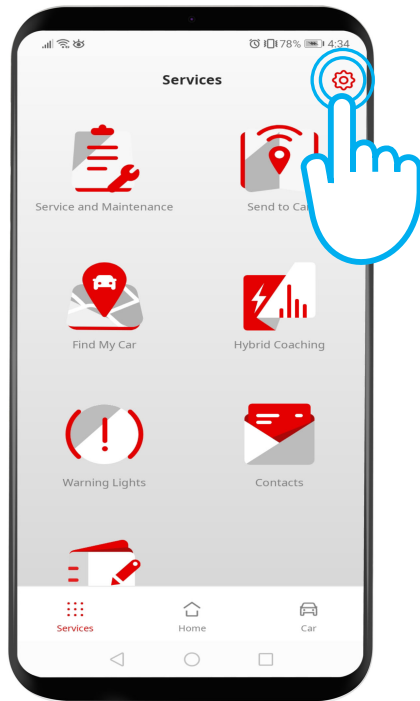

Scroll down

How to remove the car from your account?

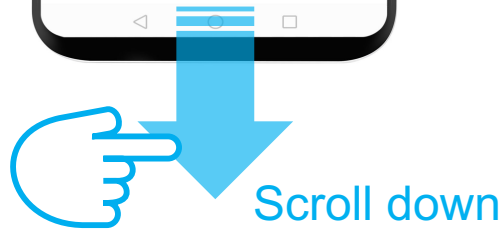
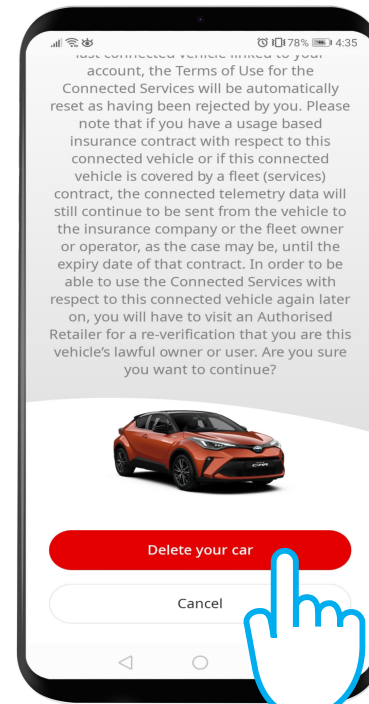
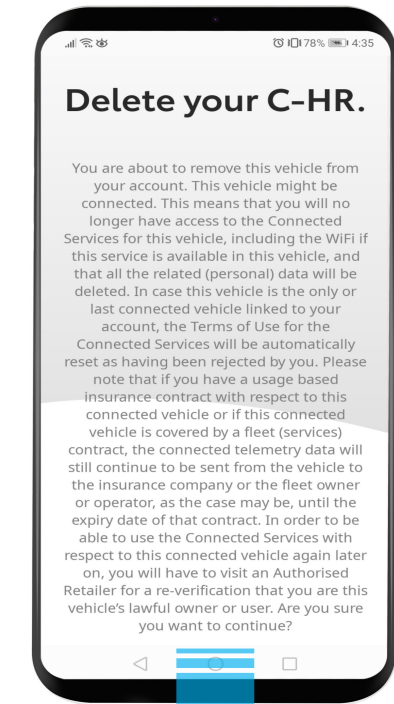
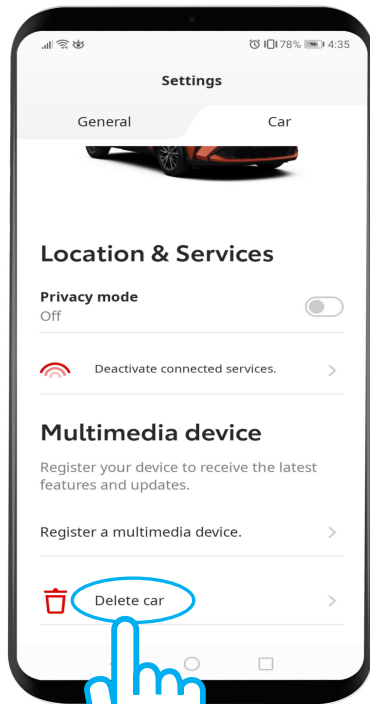

MyT | App

Life happens when you connect

MyT | Connected
Services